



VICTORY PLUS



VICTORY PLUS Model number:

3 beds • 2 baths • 1165 sq.ft. • 16' width • 76' depth

Our home building facilities invest in continuous product and process improvements. Plans, dimensions, features, materials, specifications and availability are subject to change without notice or obligation. Renderings and floor plans are representative likenesses of our homes and may differ from the actual homes. We invite you to tour a Home Center near you and inspect the highest value in quality housing available or call (337) 436-7822 to speak with a Home Consultant. Copyright 2017, CMH. All rights reserved.

<https://www.claytonlakecharles.com>

CLAYTON HOMES-LAKE CHARLES

**981 GERSTNER MEMORIAL BLVD
LAKE CHARLES, LA 70601**

Monday - Thursday: 9am to 6pm
Friday: 9am to 6pm
Saturday: 9am to 5pm
Sunday: Closed

(337) 436-7822



VICTORY PLUS

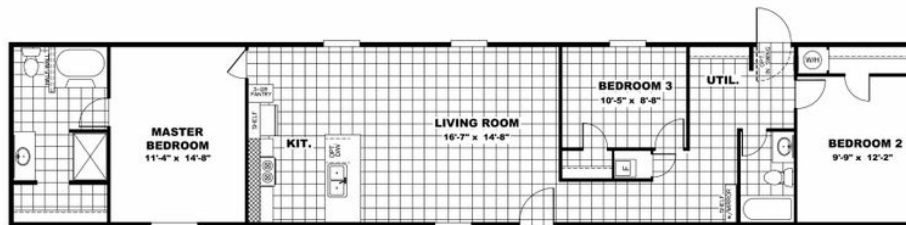

VICTORY PLUS Model number:

3 beds • 2 baths • 1165 sq.ft. • 16' width • 76' depth

Our home building facilities invest in continuous product and process improvements. Plans, dimensions, features, materials, specifications and availability are subject to change without notice or obligation. Renderings and floor plans are representative likenesses of our homes and may differ from the actual homes. We invite you to tour a Home Center near you and inspect the highest value in quality housing available or call (337) 436-7822 to speak with a Home Consultant. Copyright 2017, CMH. All rights reserved.

<https://www.claytonlakecharles.com>

CLAYTON HOMES-LAKE CHARLES

981 GERSTNER MEMORIAL BLVD
LAKE CHARLES, LA 70601

Monday - Thursday: 9am to 6pm
Friday: 9am to 6pm
Saturday: 9am to 5pm
Sunday: Closed

(337) 436-7822